

EXTREMELY RELIABLE

Pumping of high solids & abrasive slurries

FITEC KV20 BALL VALVE PUMP

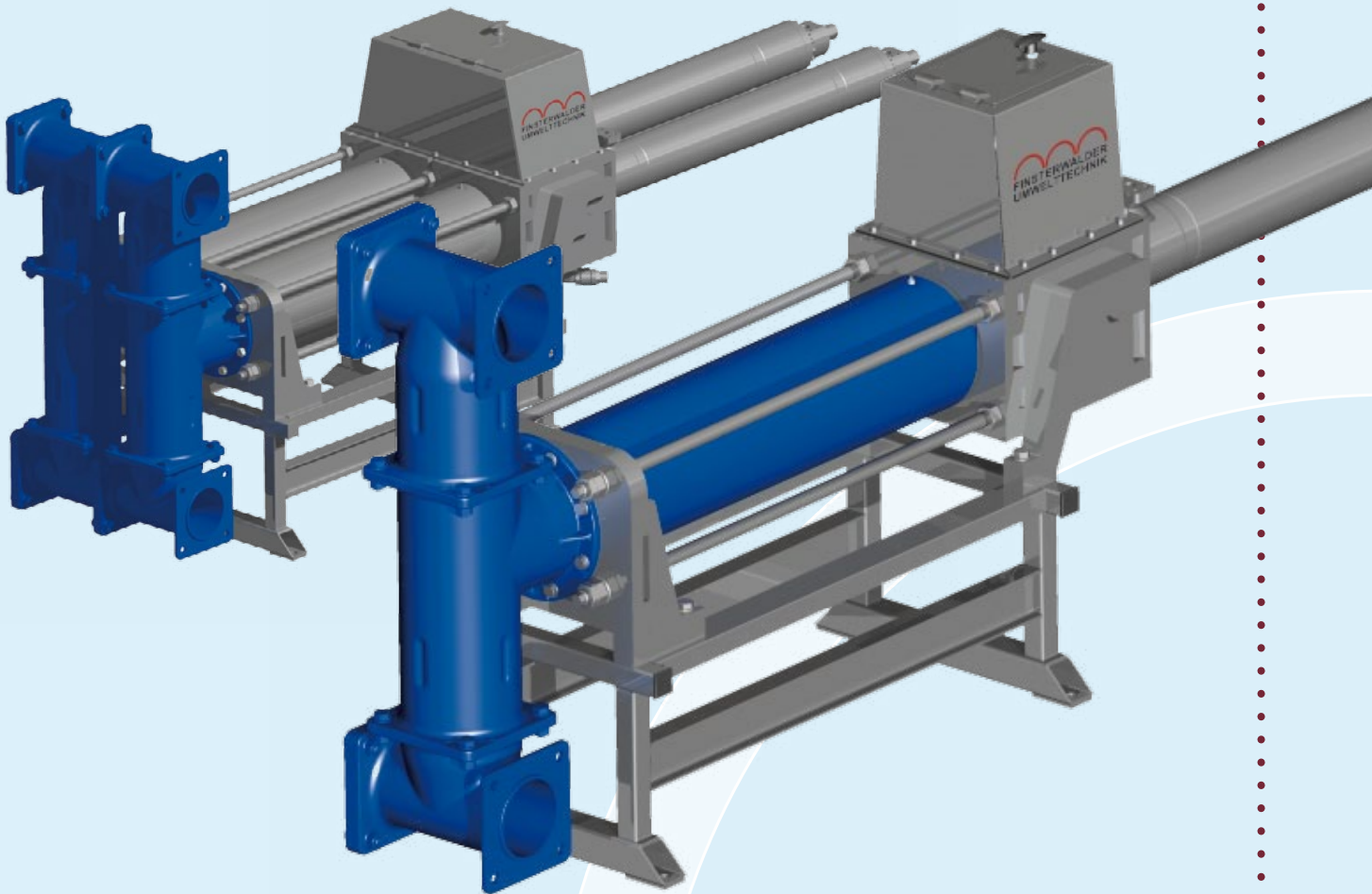

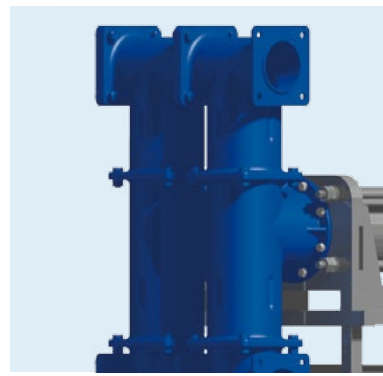
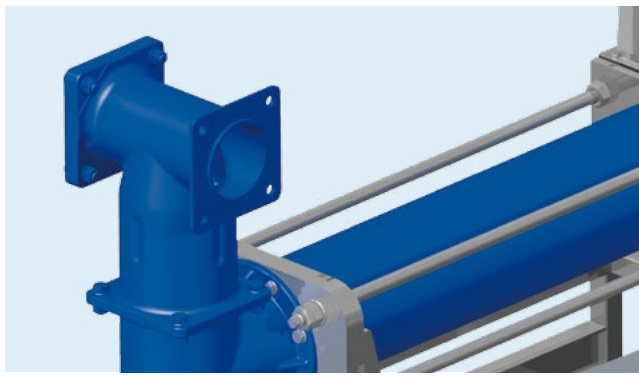
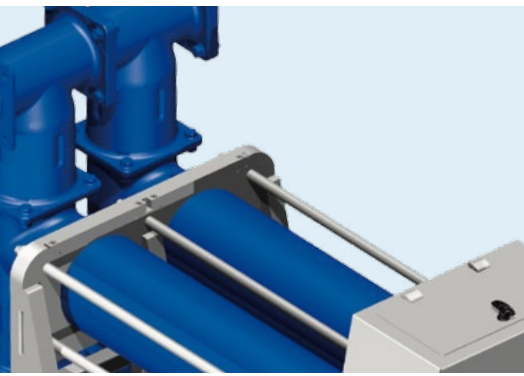

WORKING PRINCIPLE OF THE FITEC KV20 BALL VALVE PUMP

DURING SUCTION:

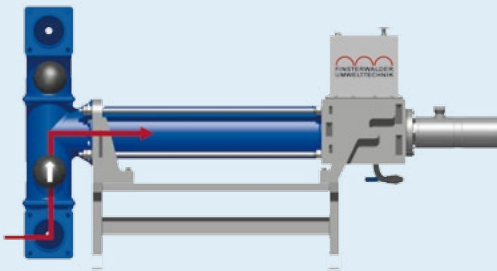

When the piston is retracted, a vacuum is created inside the cylinder due to a differential pressure, which then closes the outlet valve and subsequently the inlet valve to open.

DURING PUSHING:

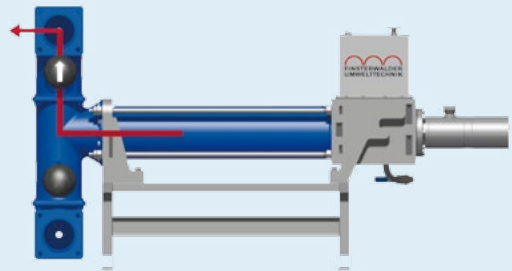

When the piston moves forward towards the valve, it creates an overpressure, which closes the inlet valve and the outlet valve opens.

KEY FEATURES OF THE KV20:

- » No rotating parts which means an extremely robust and low wearing pump which is resistant to hard particles like metal, bones and glass.
- » Can pass large particle sizes up to 30 mm
- » Can pump hot substrates up to 80 °C (176 °F)
- » Achieve flow rates up to 30 m³/h
- » Create pressures up to 30 bar



PUMP CHARACTERISTICS

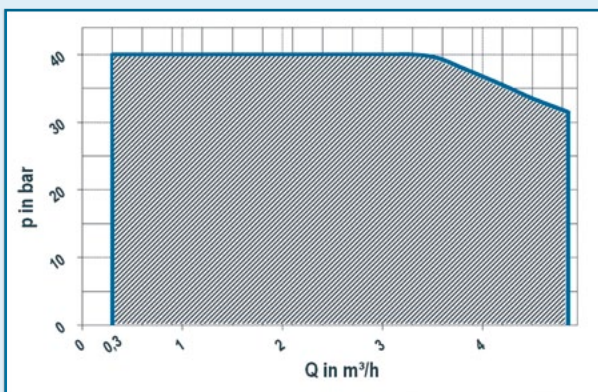

Pump curve "high-pressure pump" (2 valves)

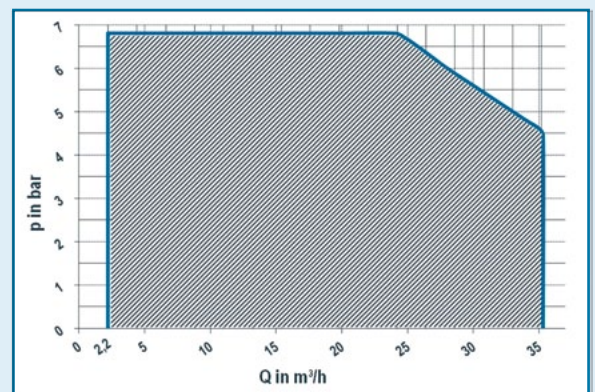

Pump curve "low-pressure pump" (2 valves)

1. High pressure option with a lower flow rate. Used for slower, steady pumping applications such as for feeding the FITEC double-tube heat exchanger.
2. Low pressure option with a high flow rate. Provides quick, high volume pumping for applications such as digester feeding or loading pretreated food waste slurries into trucks.

FITEC KV pumps can handle all kinds of slurries and sludges and the pumps can be customized to your specific requirements.

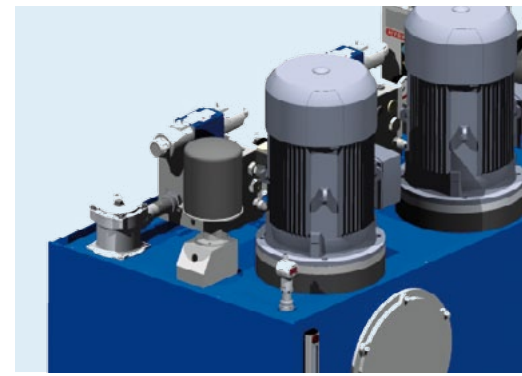
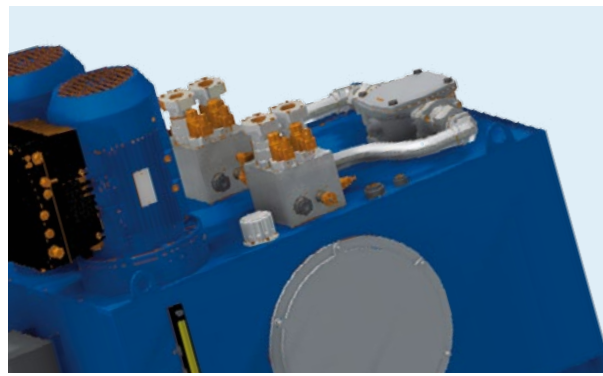
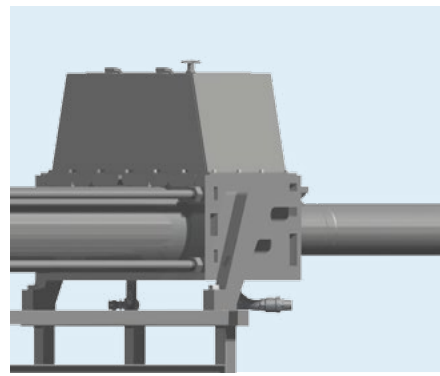

OPTION #1: SINGLE BALL VALVE PISTON PUMP

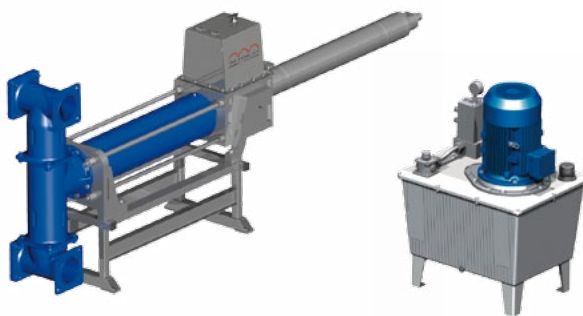

- » Low investment costs
- » Simple construction & flexible use
- » Very low operating costs

OPTION #2: DOUBLE BALL VALVE PISTON PUMP

- » Simple construction & flexible use
- » Control of the hydraulic cylinders with a swing-circuit – using one oil pump
- » Hydraulic cylinders are independently controlled – using two oil pumps
- » Very low operating costs

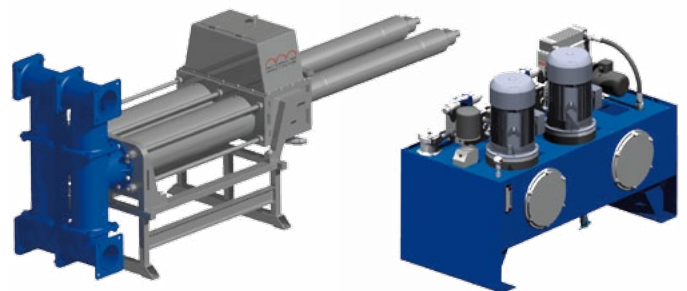

OPTION #3: PULSATION-FREE DOUBLE BALL VALVE PISTON PUMP



- » Pulsation-free operation
- » Two independently driven oil pumps
- » Highly energy efficient
- » No oil cooler required
- » Very low operating costs

**Finsterwalder Umwelttechnik
GmbH & Co. KG**

Mailing Weg 5

83233 Bernau, GERMANY

Phone: +49 (0) 8051 96 59 10-0

Telefax: +49 (0) 8051 96 59 10-20

info@fitec.com

www.fitec.com

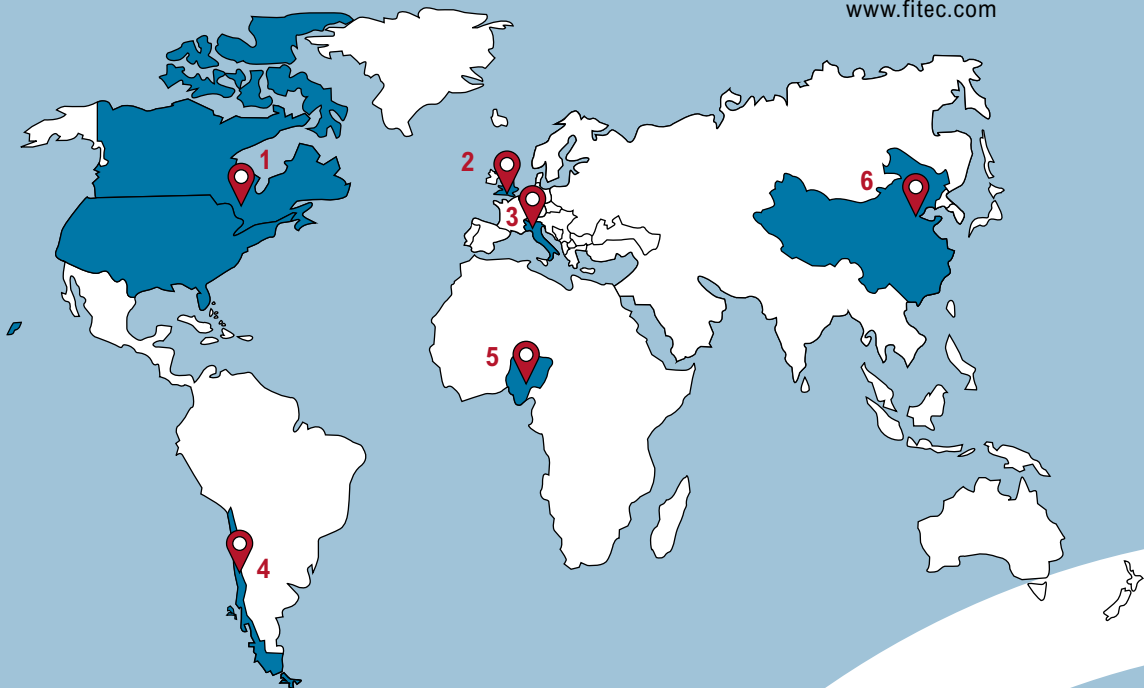

Our Partners



1 Yield Energy Inc. | Canada, North America
www.yieldbiogas.com



2 GPJ Renewables Ltd. | United Kingdom (UK)
www.gpjrenewables.com



3 Biogas Lombardia | Italy
www.biogaslombardia.it



4 SK Ecologia S.A. | Chile
www.ske.cl



5 Eongratis Ltd. | Nigeria
www.eongratis.com



6 Fitec (Tianjin) | China
Environmental Technology Co., Ltd.
www.fitec.cn